

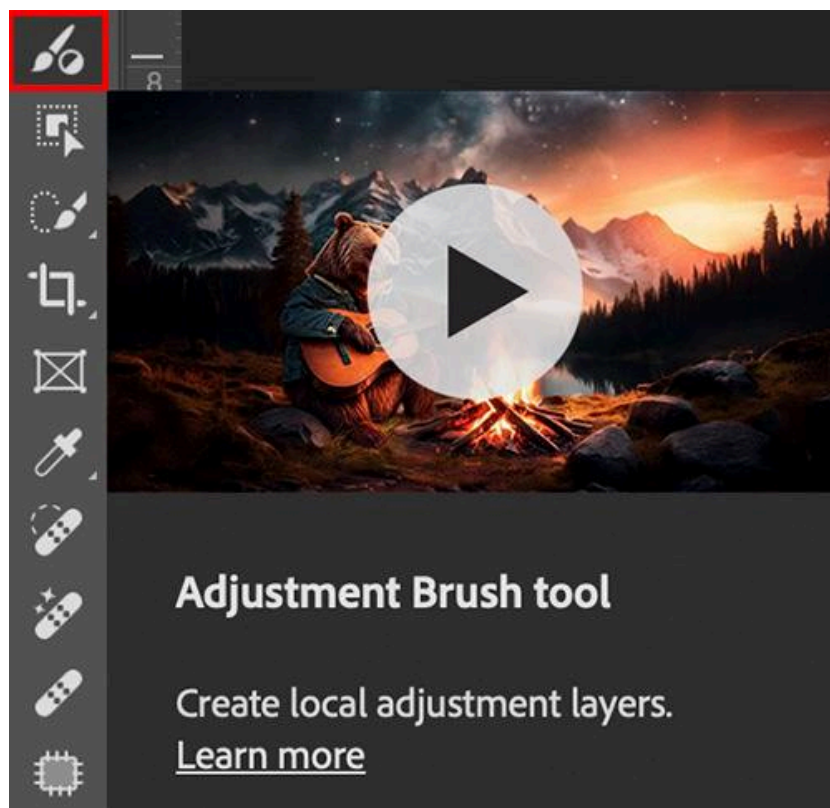

# SHUTTER BUG ACADEMY

"Free for Personal Use!"

## Adjustment Brush



The **Adjustment Brush** above is a new manual way to make a selective adjustment. Instead of making a selection, you brush over the area you would like to select. One advantage of the adjustment brush is its ability to add a feather. The way it works is you first need to choose the type of adjustment. In the image above, it is a black and white adjustment. The brush over the area you would like to apply the black and white adjustment.

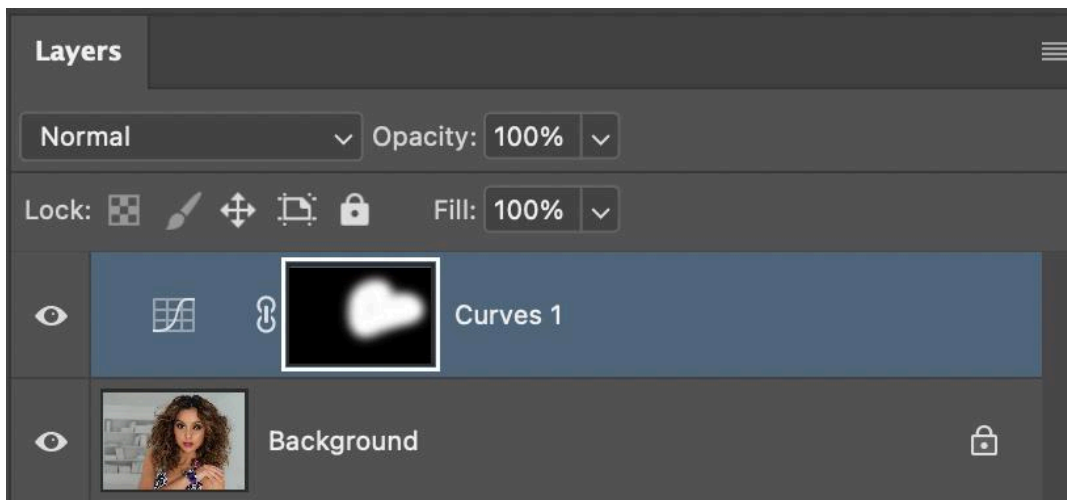

The above image is an example of a Curves adjustment using the adjustment brush. The area in white was applied to the mask to make a curves adjustment.

## Manual Selective Adjustment

A manual selective adjustment is essentially the same, but we will use the Brush Tool to apply the white into the mask. Here are the steps.

1. Make an adjustment in this case Curve, and make an adjustment in Properties..
2. Turn the white mask, black using Cmd-I on MAC and Ctrl-I on PC.
3. Brush white into the mask and you are done.

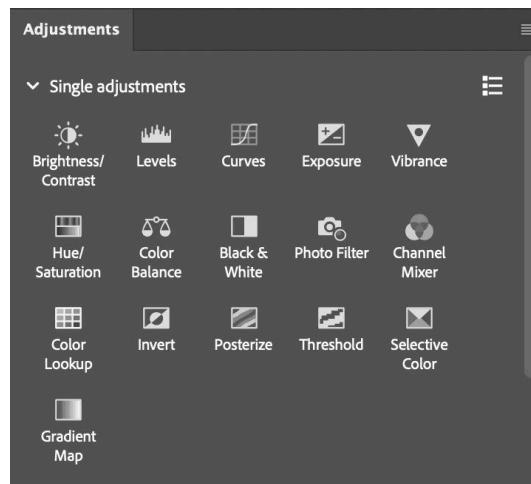
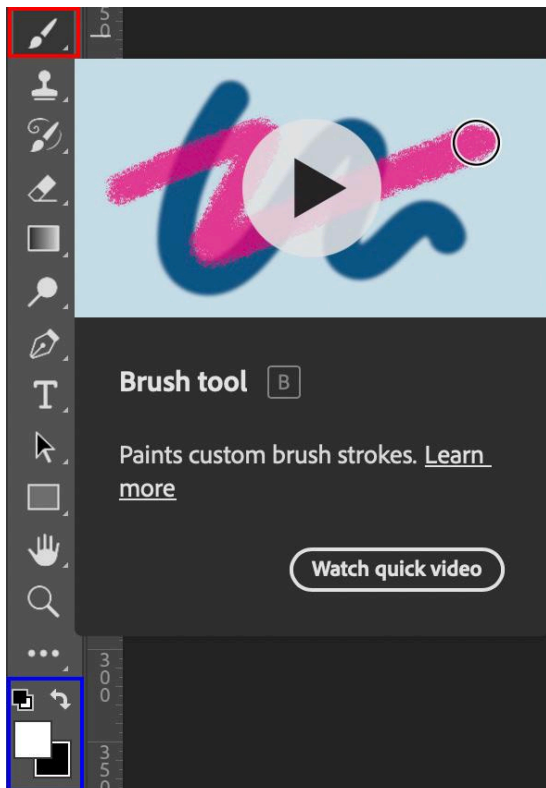

Above is the adjustments window. To the left are the brush tool in red, and the foreground/background colors in blue. The arrow will switch the background to foreground. The color in the front is the color you are applying to the mask.